

**Bracket & PCB Assembly (PCB, 33-0000)**

BILL OF MATERIAL:			
PART #	PART DESCRIPTION	QTY	<input checked="" type="checkbox"/>
33-1111	Bracket	1	<input type="checkbox"/>
33-2222	Bracket Nut	2	<input type="checkbox"/>
33-3333	PC Board	1	<input type="checkbox"/>
33-4444	Resistor-1	2	<input type="checkbox"/>
33-5555	Resistor-2	1	<input type="checkbox"/>
33-6666	PC Board Pin	2	<input type="checkbox"/>
WHEN COMPLETE: INITIAL & DATE →			

**NOTE:** Refer to [Figure 5](#) and [Figure 6](#) and [Figure 7](#)

1.0. PCB Board Assembly:

- 1.1 Place the PCB Board (33-3333, 1x) into the Vice Clamp.
- 1.2 Using Soldering Iron and Solder, solder the following components onto the PCB Board:
  - Solder Resistor-1 (33-4444, 3x) onto the PCB Board
  - Solder Resistor-2 (33-5555, 2x) onto the PCB Board
- 1.3 Using Wire Cutter, cutoff the excess leads of the Resistor.
- 1.4 Using IPA Alcohol and Q-tip clean up the surfaces of the Tabs.

2.0. Mount the PCB Board onto the Bracket (33-1111, 1x) using PCB Board Pins (33-6666, 2x).

3.0. Bracket Nuts (33-2222, 2x) will be used later in the Contact Switch Assembly.

FIGURE 5. Bracket & PCB Board Assembly (View 1)

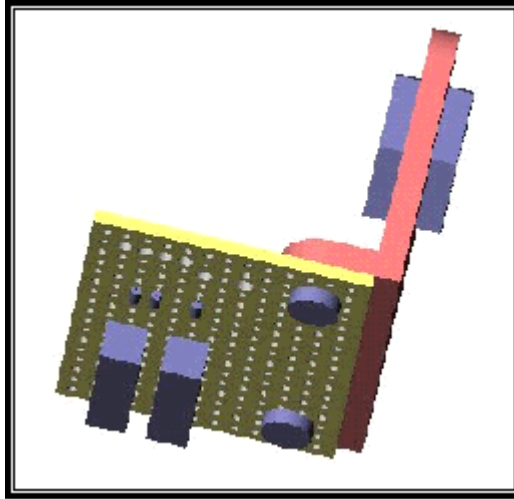
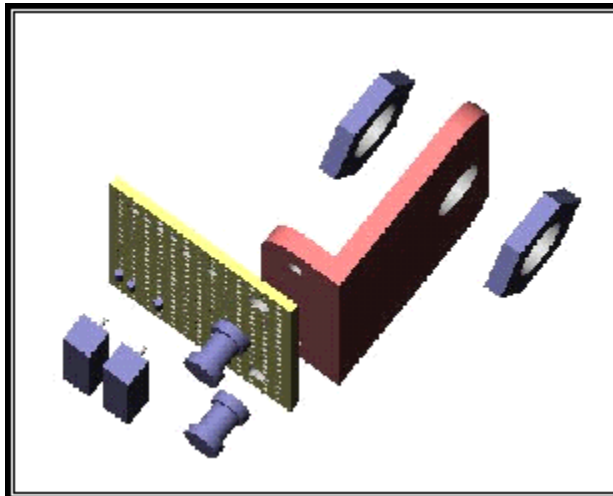

FIGURE 6. Bracket & PCB Board Assembly (View 2)



---

FIGURE 7. Bracket & PCB Board Assembly (View 3)

---

